

# 37 Ft Medical Mobile Clinic

with 2 Exam Rooms & Reception/Waiting Room

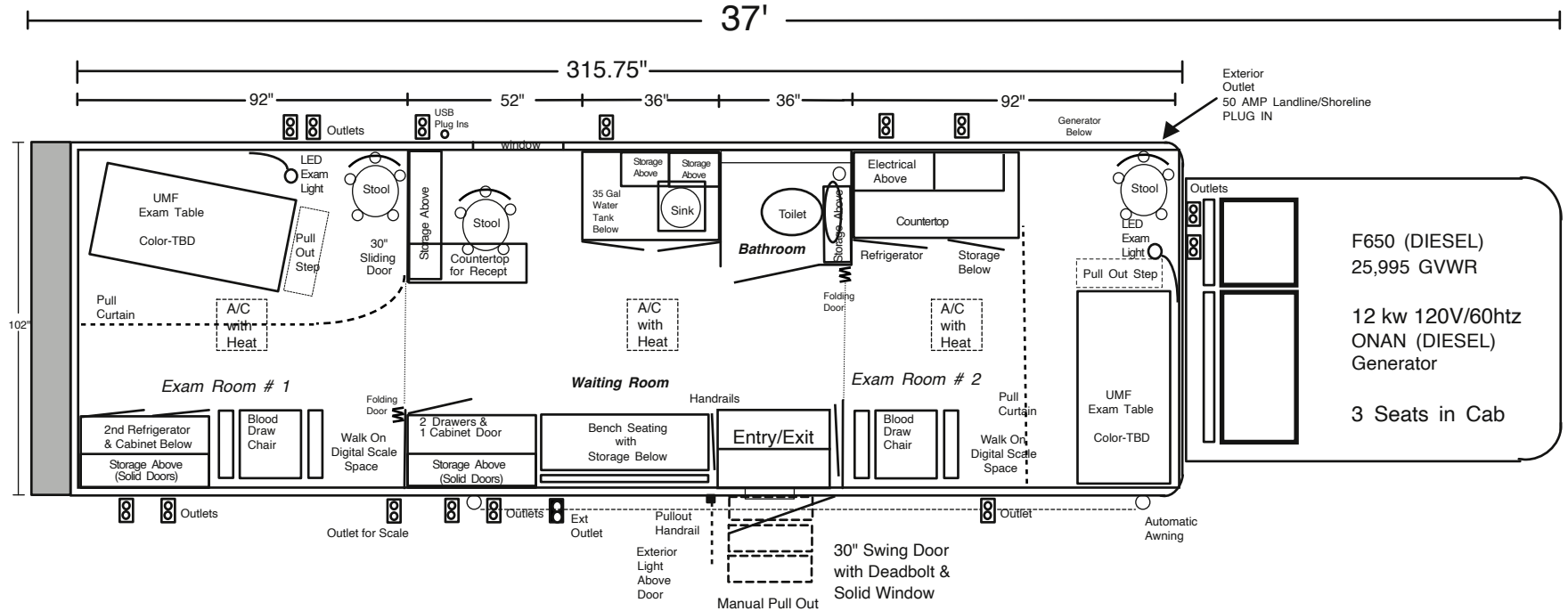

F650 (DIESEL)  
25,995 GVWR  
  
12 kw 120V/60hz  
ONAN (DIESEL)  
Generator  
  
3 Seats in Cab

### Includes:

Video Camera for Backing Up  
ONAN Commercial DIESEL - Generator 12 kw 120V in 60 hz  
LED Interior Lighting (4 Per Room, 12 Total)  
AGM Battery 105 Amp Hr on a 35 Amp Charger  
Bench Seating - Color (TBD)  
Two (2) Exam Tables - Color (TBD)  
Stool - Colors (TBD)  
Three (3) A/C Units 15K BTU with Heat Pump - T-Stat controlled  
Interior laminate to be **GREY** for cabinets, interior walls, storage  
Commercial Flooring - **BLACK**  
Countertops to be Faux **Marble White** Color  
Under Floor Storage Compartments (Approx. Size 4 @ 46"x22"x26")  
(2 Open, 1 for Gen Comp, 1 for Grey/Black Tank)  
Interior Height to 84" (Approx.)  
All Standard Features Included

### Options:

Two (2) Exam Flexible Lights LED  
Two (2) Blood Draw Chairs (Color - TBD)  
Stabilizing 2 Pt Manual System  
Exterior Outlet on Passenger Side  
2nd Medical Fridge in Rear Room  
Solar Panel System  
Hot Water Tank 2.5 Gal  
Automatic Awning - Color - TBD  
Exterior Graphics Package (TBD)  
Delivery

Scale 1/4" = 1'  
(approximate)

Please Sign and Email back to us ASAP  
Accepted by \_\_\_\_\_  
Date \_\_\_\_\_

