

26 Ft Mobile Dental Clinic - Professional Series

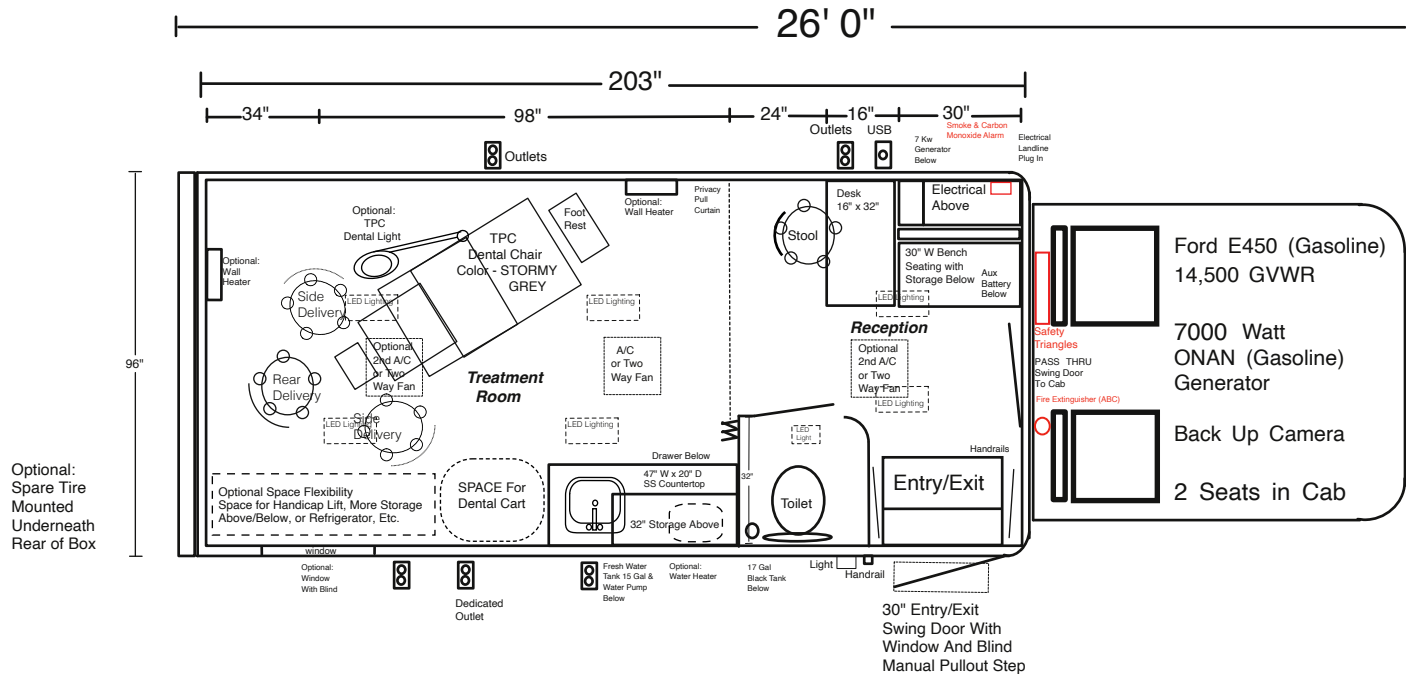

Includes:

- Commercial Flooring - BLACK
- ONAN Commercial Gas Gen EFI 7,000 Watts
- One A/C Unit (13,500 BTU T-Stat Controlled)
- Electrical Distribution Cabinet 110V & 12V
- Aux Battery, Auto Transfer Switch, and Charger
- Pass Thru to Cab with Latching Swing Door
- Lights - 6 Interior LED + Bathroom Light
- 47" W SS Countertop with SS Sink
- 30" W Bench Seat BLACK With Storage Below
- 32" W Storage Above Sink Area
- Mobile Desk with Stool BLACK With Backrest
- Privacy/Sound Curtain Separating Rooms BLACK
- Bathroom With Black Tank - 17 Gal
- Fresh Water Tank - 17 Gal
- Video Camera for Backing Up
- All Standard Features

Options: (Install)

- TPC - Laguna Dental Power Chair (COLOR - STORMY GREY)
- TPC Dental Cart With Scaler and Light (MC3600CV-SL)
- TPC - Dental Light L600 LED
- Hot Water Tank - 2.5 Gal with Electrical Outlet
- Two (2) Wall Heaters - 1500 Watt
- Stabilizing/Leveling System - 2 Electric Legs in Rear
- One (1) Dedicated Outlet for Dental Cart
- Two Way 12V Roof Fan

Safety:

- Fire Extinguisher (ABC)
- Safety Triangles Behind Driver's Seat in Box
- Smoke & Carbon Monoxide Alarm

Scale 1/4" = 1'
(approximate)

Please Sign And Email Back ASAP

Accepted by _____

Date _____

