

26 Ft Mobile Screening Clinic - Professional Series

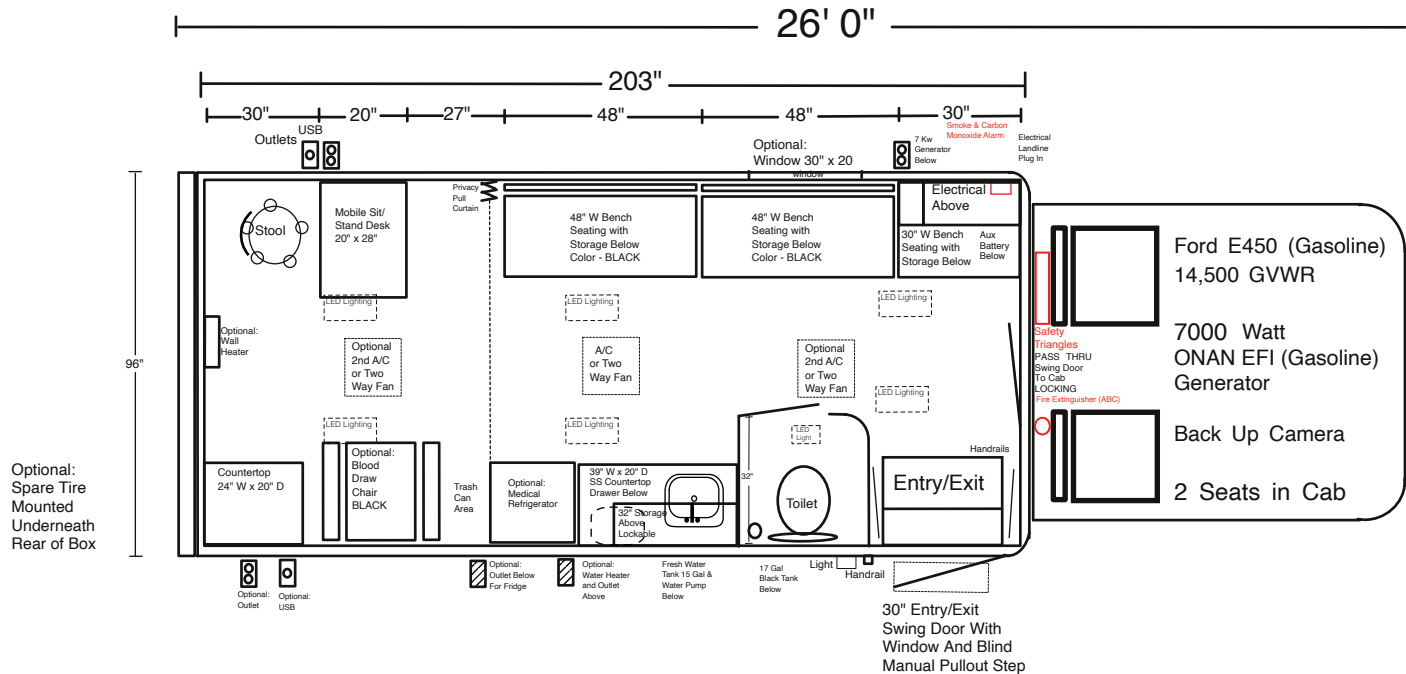

Includes:

Commercial Flooring - BLACK
 ONAN Commercial Gas Gen EFI 7,000 Watts
 One A/C Unit (13,500 BTU T-Stat Controlled)
 Electrical Distribution Cabinet 110V & 12V
 Aux Battery, Auto Transfer Switch, and Charger
 Pass Thru to Cab with Latching Swing Door
 Lights - 6 Interior LED + Bathroom Light
 39" W SS Countertop with SS Sink
 30" W Bench Seat BLACK With Storage Below
 Two (2) 48" W Bench Seat BLACK With Storage Below
 32" W Storage Above Sink Area
 Mobile Desk with Stool BLACK With Backrest
 Privacy/Sound Curtain Separating Rooms BLACK
 Fresh Water Tank - 17 Gal
 Bathroom With Black Tank - 17 Gal
 Video Camera for Backing Up
 24" x 20" D Countertop on Pass Side
 All Standard Features

Options: (Installed)

Hot Water Tank - 2.5 Gal with Electrical Outlet
 One (1) Wall Heater - 1500 Watt
 Spare Tire Mounted Underneath Rear of Box
 Slider Window 30 x 18 with Blind on Driver Side
 Blood Draw Chair (Color - BLACK)
 Medical Refrigerator 3 Cu Ft

Safety:

Fire Extinguisher (ABC)
 Safety Triangles Behind Driver's Seat in Box
 Smoke & Carbon Monoxide Alarm

Scale 1/4" = 1'
 (approximate)

Please Sign And Email Back ASAP

Accepted by _____
 Date _____

