

# 26 Ft Mobile Medical Clinic - Professional Series

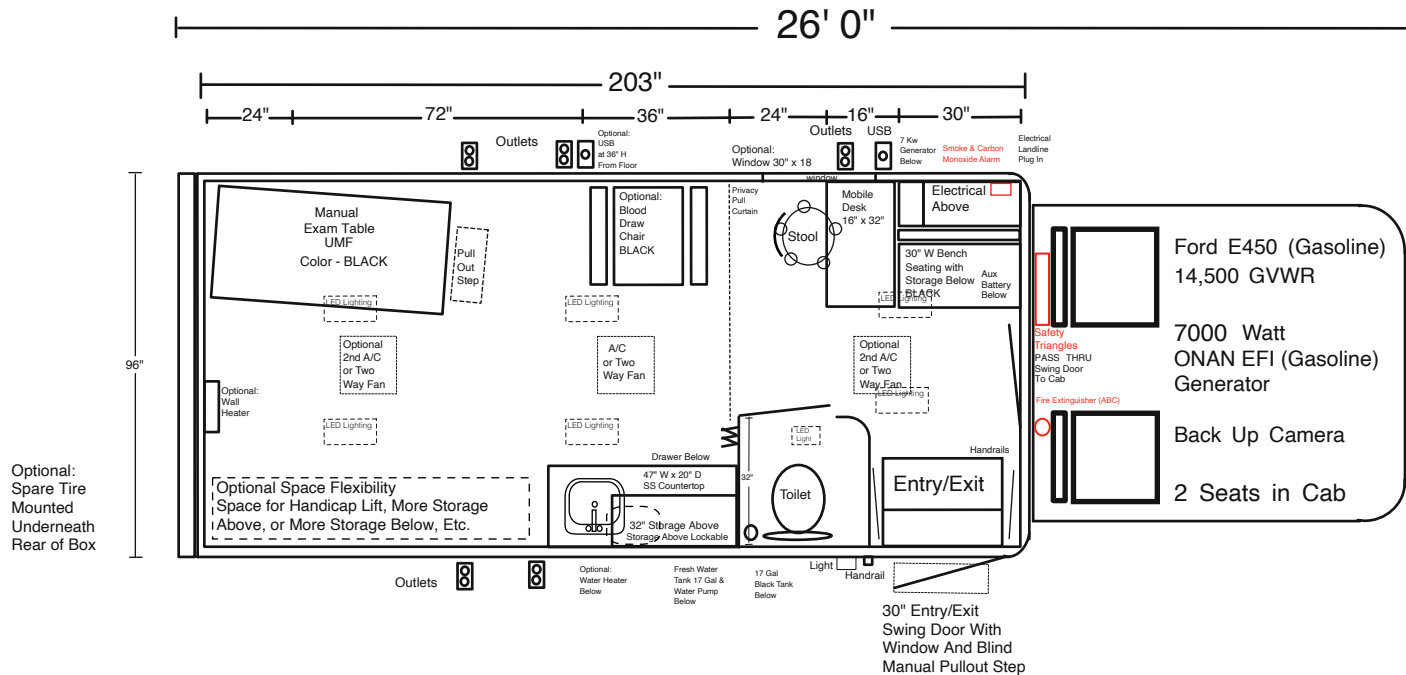

**Includes:**

- Commercial Flooring - BLACK
- ONAN Commercial Gas Gen EFI 7,000 Watts
- One A/C Unit (13,500 BTU T-Stat Controlled)
- Electrical Distribution Cabinet 110V & 12V
- Aux Battery, Auto Transfer Switch, and Charger
- Pass Thru to Cab with Latching Swing Door
- Lights - 6 Interior LED + Bathroom Light
- 47" W SS Countertop with SS Sink
- 30" W Bench Seat BLACK With Storage Below
- 32" W Storage Above Sink Area
- Mobile Desk with Stool BLACK With Backrest
- Privacy/Sound Curtain Separating Rooms BLACK
- Fresh Water Tank - 17 Gal
- Bathroom With Black Tank - 17 Gal
- Video Camera for Backing Up
- All Standard Features

**Options: (Installed)**

- Exam Table 5250 UMF Manual Front Step With Storage Drawers
- Hot Water Tank On Wall - 2.5 Gal with Electrical Outlet
- One (1) Wall Heater - 1500 Watt
- Spare Tire Mounted Underneath Rear of Box
- Slider Window 30 x 18 with Blind on Driver Side
- Blood Draw Chair (Color - BLACK)

**Safety:**

- Fire Extinguisher (ABC)
- Safety Triangles Behind Driver's Seat in Box
- Smoke & Carbon Monoxide Alarm

Rep \_\_\_\_\_



Scale 1/4" = 1'  
(approximate)

Please Sign And Email Back ASAP

Accepted by \_\_\_\_\_

Date \_\_\_\_\_